

STRUCTURE DIAGRAM

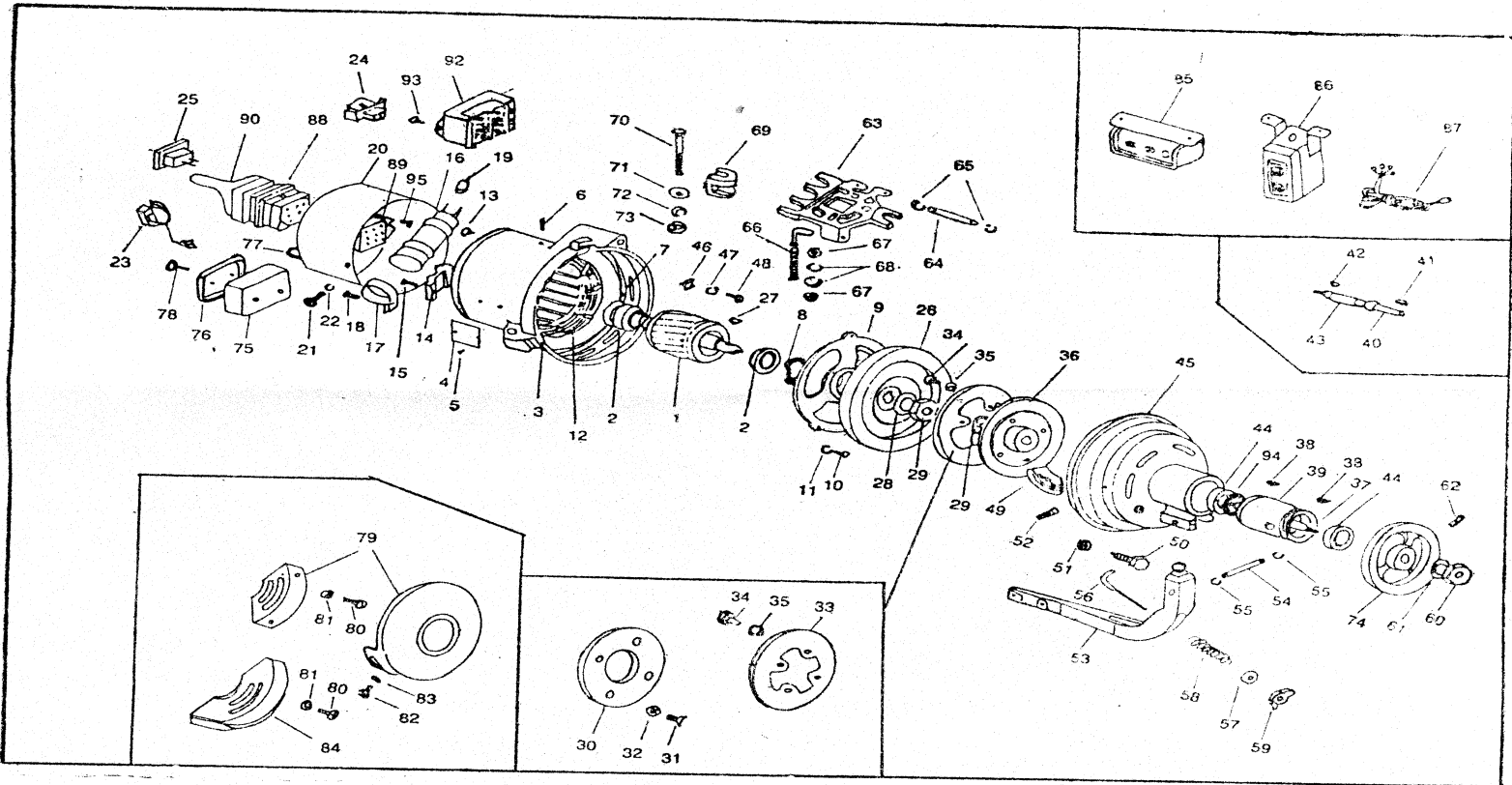

PARTS LIST

Ref. No.	Name of parts	Q'ty	Ref. No.	Name of parts	Q'ty	Ref. No.	Name of parts	Q'ty
1	rotor	1	36	clutch plate	1	71	plan washer for No. 70	3
2	ball bearing #6203	2	37	clutch shaft	1	72	spring washer for No. 70	3
3	frame	1	38	woodruff key for No. 37	2	73	nut No. 70	3
4	medallion	1	39	clutch adjusting sleeve	1	74	pulley (pls indicate size)	1
5	rivet	4	40	clutch shaft (AMCO)	1	75	box for terminal board	1
6	set screw for No. 12	1	41	key for No. 40 (AMCO)	1	76	cover	1
7	neoprine thrust washer	1	42	woddruff key for No. 40	1	77	rubber bushing	1
8	wave washer 40φ	1	43	shaft pipe spacer (AMCO)	1	78	set screw for No. 75	2
9	center bracket	1	44	ball bearing #6202	2	79	belt cover (full enclosed)	1
10	set screw for No. 9	3	45	pulley side end bracket	1	80	set screw fro No. 79, 84	2
11	spring washer for No. 9	3	46	clutch end cover clamp	3	81	washer for No. 79, 84	2
12	stator	1	47	spring washer for No. 46	3	82	set screw for No. 79	2
13	set screw for earth	1	48	set screw for No. 46	3	83	washer for No. 79	2
14	terminal board	1	49	brake shoe	1	84	belt cover (half)	1
15	set screw for No. 14	2	50	brake adjusting screw	1	85	push button switch only	1
16	capacitor	1	51	nut for No. 49	1	cs85	push botton switch, wire	1
17	capacitor band	2	52	set screw for No. 49	1	86	safety switch only	1
18	set screw for No. 17	2	53	clutch lever	1	cs86	safety switch, wire	1
19	terminal boots	2	54	lever pin	1	87	power cord with earthwire	1
20	end cover	1	55	stop spring	2	88	reversing plug (male)	1
21	set screw for No. 20	2	56	lever adjusting screw	1	89	reversing plug (female)	1
22	washer for No. 20	2	57	washer for No. 56	1	90	cap for No. 88	1
23	heyco bushing	1	58	spring washer for No. 56	1	91	set screw for No. 89	2
24	receptacle for light	1	59	wing nut for No. 56	1	92	110/220v change switch	1
25	receptacle for light	1	60	pulley lock nut	1	93	set screw for No. 92	2
26	fly wheel	1	61	spring washer for No. 60	1	94	spacer ring	1
27	woodruff key for No. 26	1	62	set screw for pulley	1			
28	washer for No. 26, 36	1	63	slide base	1			
29	hexagonal nut for No. 26, 36	1	64	base pin	1			
30	clutch lining	1	65	stop ring for No. 64	2			
31	set screw for No. 30	4	66	belt adjusting bolt	1			
32	stop washer for No. 30.	4	67	nut for No. 66	2			
33	clutch lining	1	68	spring washer for No. 66	2			
34	set screw for No. 33	4	69	vibration absorbing rubber	3			
35	stop washer for No. 33	4	70	motor set screw	3			