

chandler  **WORLD
FAMOUS**

**MODEL
CM491**

BUTTON SEWING MACHINE



**PARTS
BOOK**

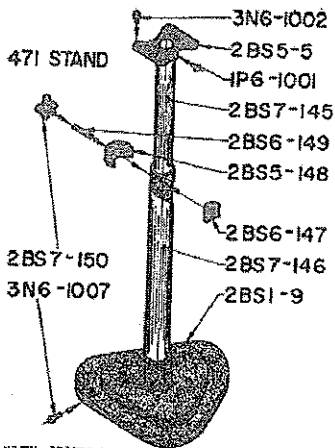

WHEN ORDERING THIS UNIT COMPLETE, PLEASE REFER TO NO. 2BS8-22

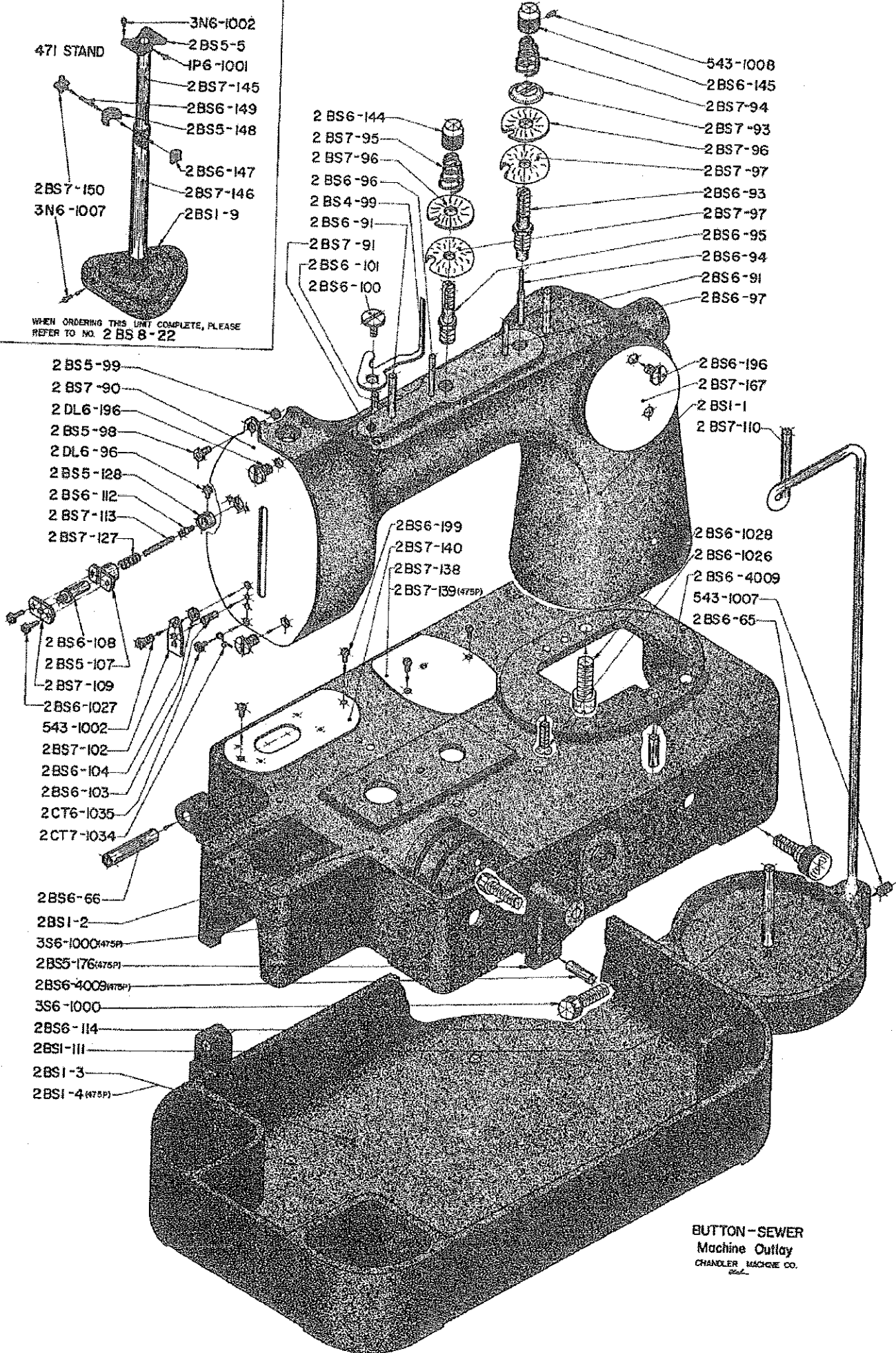

BUTTON-SEWER
Machine Outlay
CHANDLER MACHINE CO.

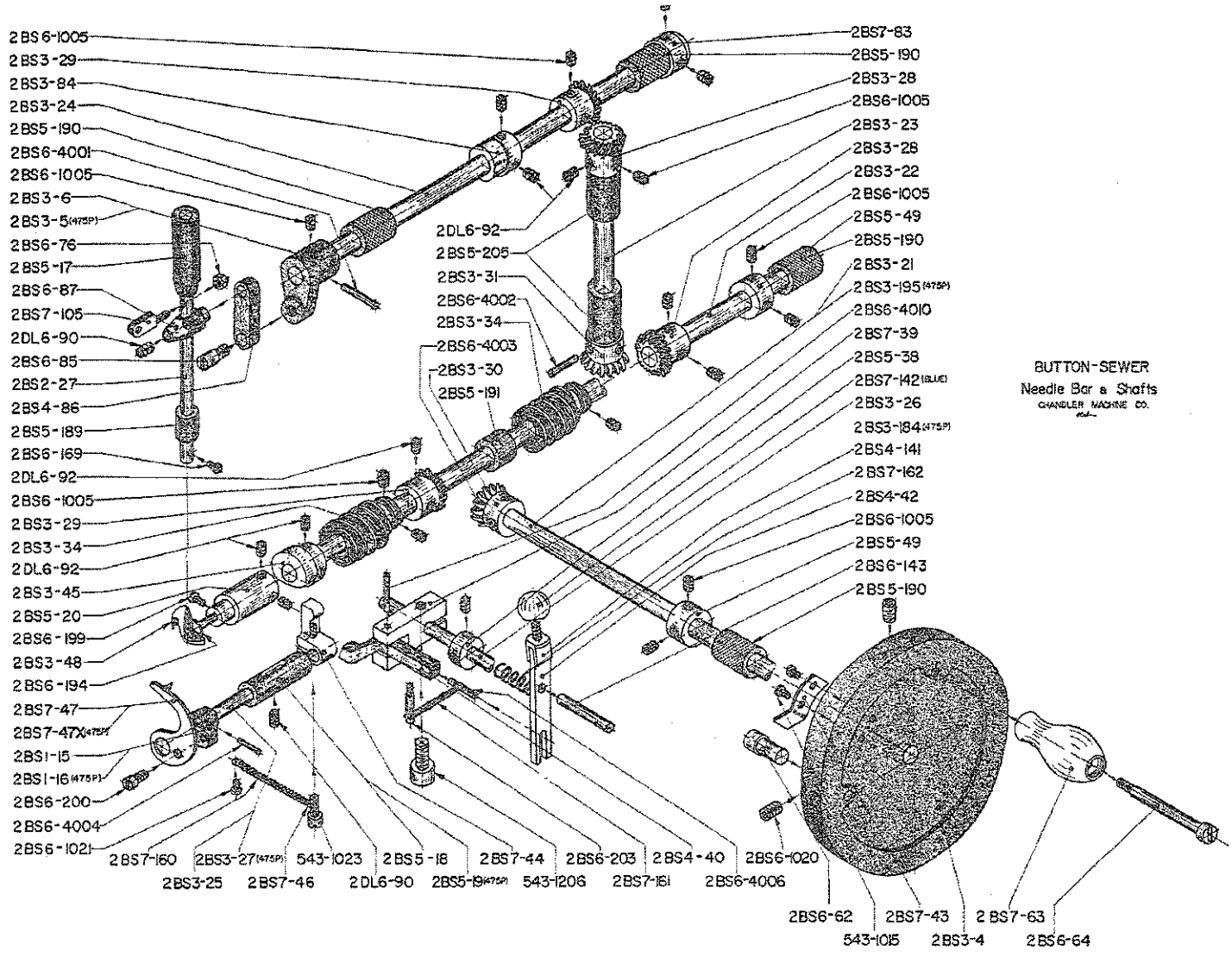

BUTTON-SEWER
 Needle Bar & Shafts
 CHANDLER MACHINE CO.
 Pat.

HAND-BUTTON-SEWER
471 Linkage
CHANDLER MACHINE CO.
MILWAUKEE

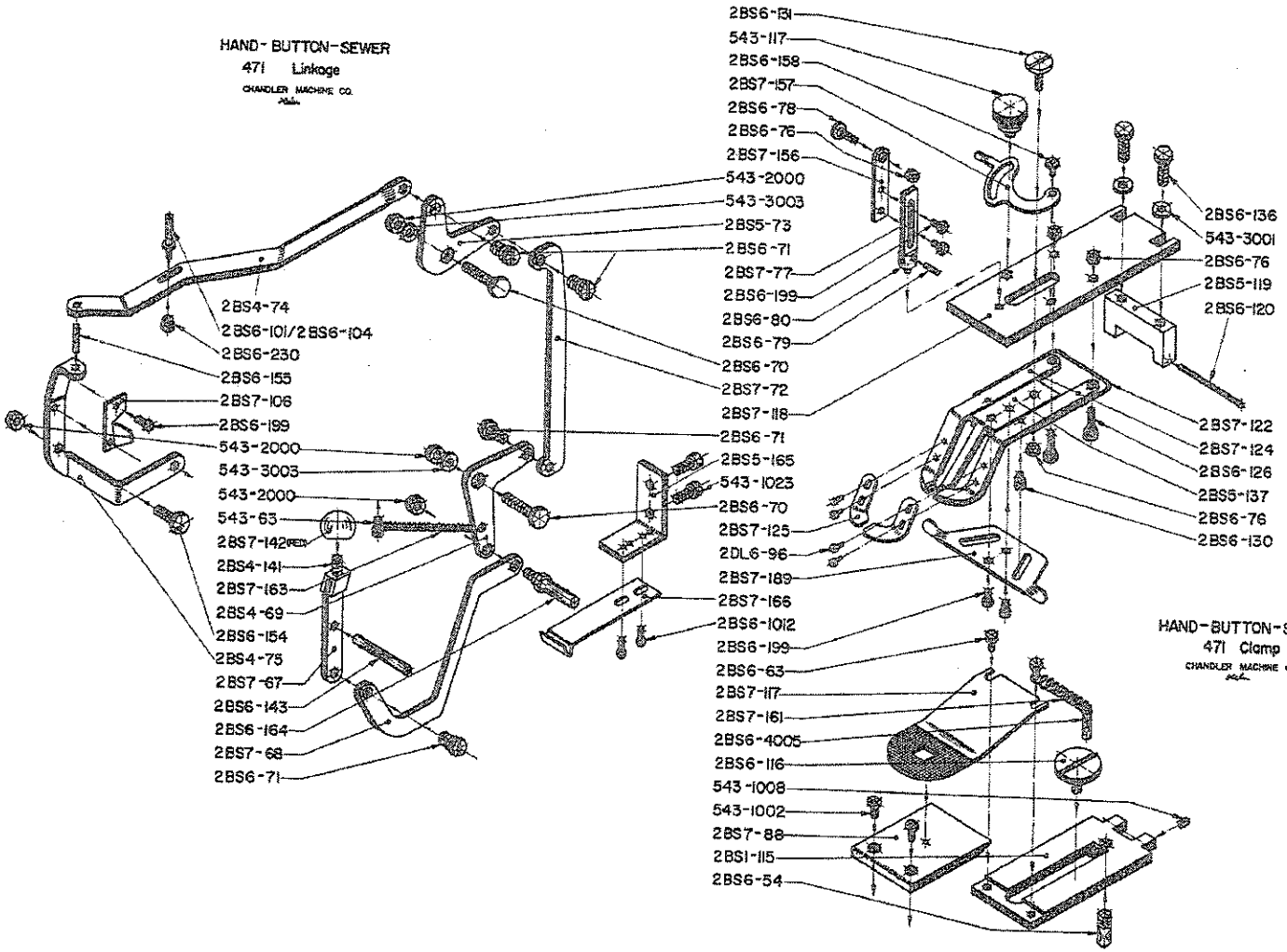

HAND-BUTTON-SEWER
471 Clamp
CHANDLER MACHINE CO.
MILWAUKEE

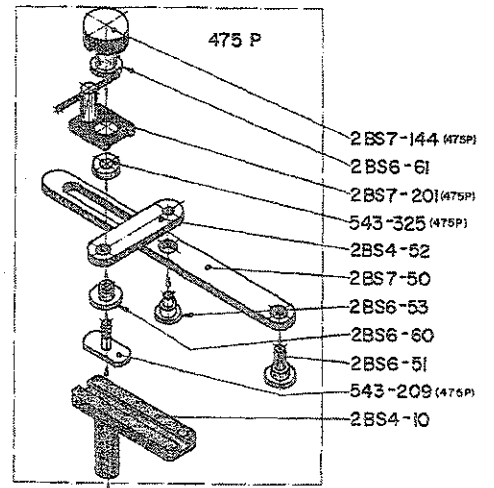
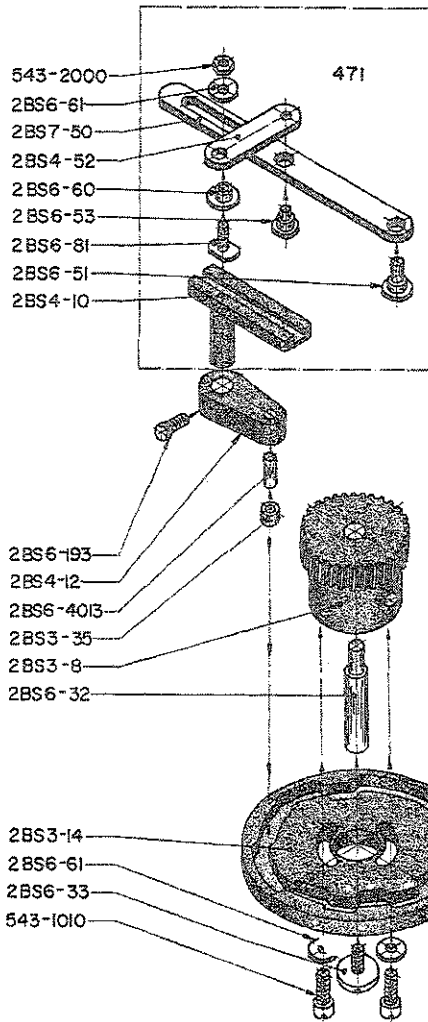
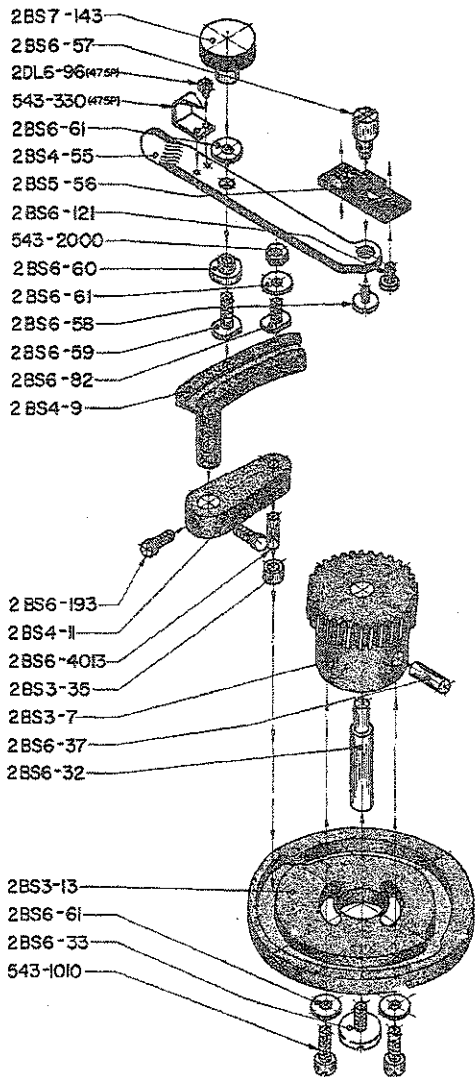

BUTTON SEWER
 Gears & Cams
 CHANDLER MACHINE CO.
 1926

BUTTON-SEWER
475P Linkage
CHANDLER MACHINE CO.
2024

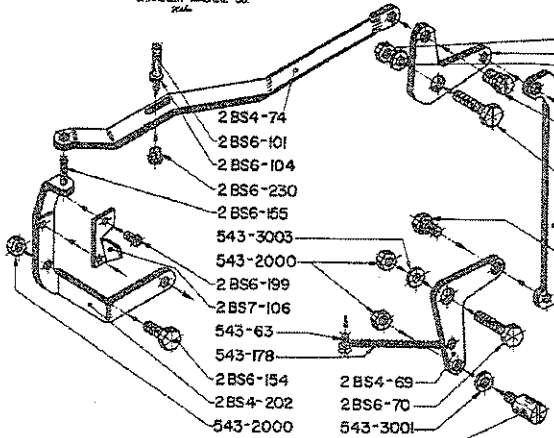

- 2BS4-74
- 2BS6-101
- 2BS6-104
- 2BS6-230
- 2BS6-155
- 543-3003
- 543-2000
- 2BS6-199
- 2BS7-106
- 543-63
- 543-178
- 2BS6-154
- 2BS4-202
- 543-2000

- 2BS4-69
- 2BS6-70
- 543-3001
- 543-75
- 543-2002

FOR SECOND PEDAL ONLY

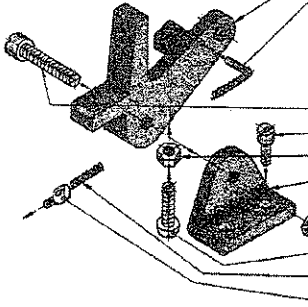

- 2BS4-179
- 2BS6-4012
- 543-1019
- 543-178
- 543-93
- 3N6-1018
- 2BS6-1023
- 543-1010
- 543-2002
- 2BS5-177
- 543-2002
- 3N6-1018
- 543-178
- 543-93

- 2BS6-131
- 543-117
- 2BS6-153
- 2BS7-157
- 2BS6-136
- 2DL6-184

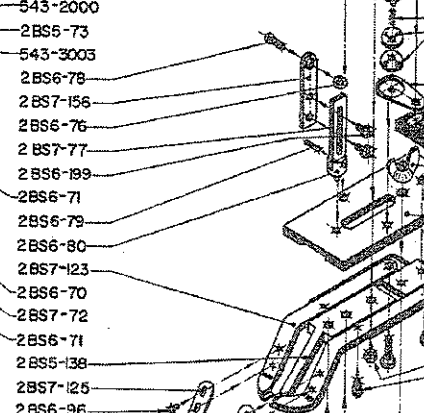

- 543-2000
- 2BS5-73
- 543-3003
- 2BS6-78
- 2BS7-156
- 2BS6-76
- 2BS7-77
- 2BS6-199
- 2BS6-71
- 2BS6-79
- 2BS6-80
- 2BS7-123
- 2BS6-70
- 2BS7-72
- 2BS6-71
- 2BS5-138
- 2BS7-125
- 2BS6-96
- 2BS4-178
- 2BS6-4012
- 2BS7-189
- 2BS6-199
- 2BS5-196
- 543-271
- 543-1010
- 2BS5-177
- 543-2002
- 2BS6-63
- 2BS6-116
- 2BS7-117
- 543-1002
- 2BS7-161
- 2BS7-89
- 543-315
- 2BS6-199

- 2DL7-175
- 2DL6-122
- 2BS6-136
- 2DL5-183
- 543-3001
- 2BS6-136
- 543-2004
- 2BS6-1025
- 2BS6-76
- 2BS7-132
- 2BS5-197
- 2BS7-122
- 2BS6-126
- 2BS6-76
- 2BS6-130

HAND-BUTTON-SEWER
475P Clamp
CHANDLER MACHINE CO.
2024

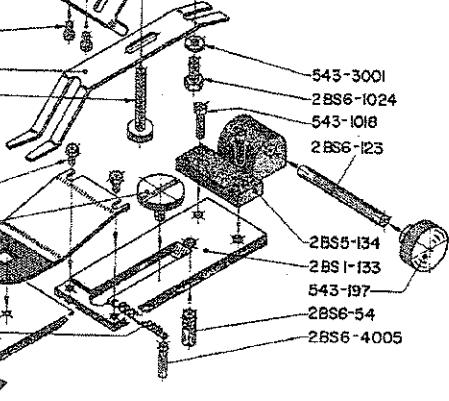

- 543-3001
- 2BS6-1024
- 543-1018
- 2BS6-123
- 2BS5-134
- 2BS1-133
- 543-197
- 2BS6-54
- 2BS6-4005

HAND-BUTTON-SEWER
 475 P CLUTCH
 CHANDLER MACHINE CO.
2020

WHEN ORDERING THIS UNIT COMPLETE,
 PLEASE REFER TO NO. 2 BS 8-23

THE FOLLOWING PARTS WILL NOT BE

- INCLUDED:
- 2 BS 3 - 185
 - 2 BS 5 - 49
 - 2 BS 5 - 190
 - 2 BS 6 - 1005
 - 2 BS 6 - 1029
 - 2 BS 9 - 210

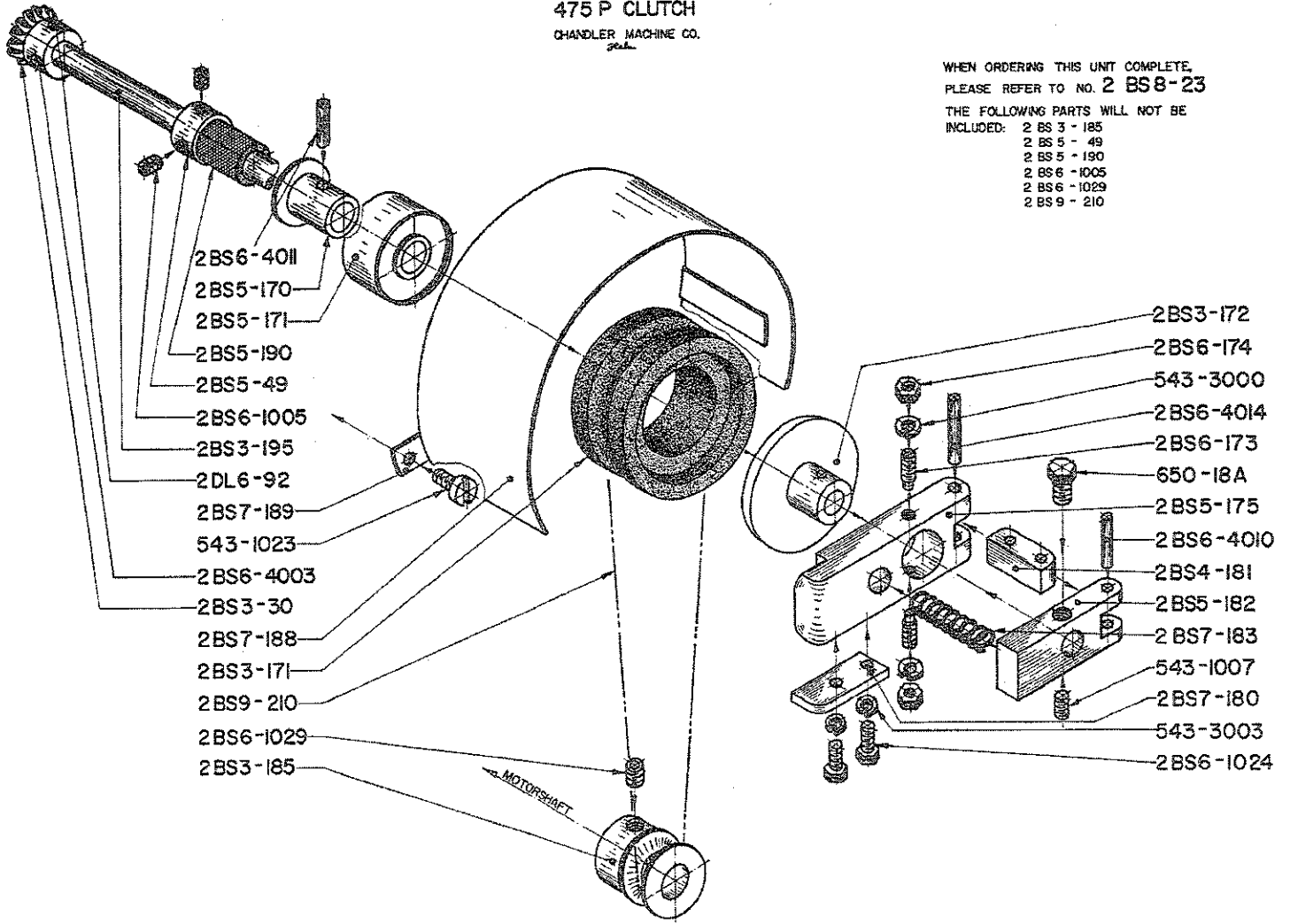

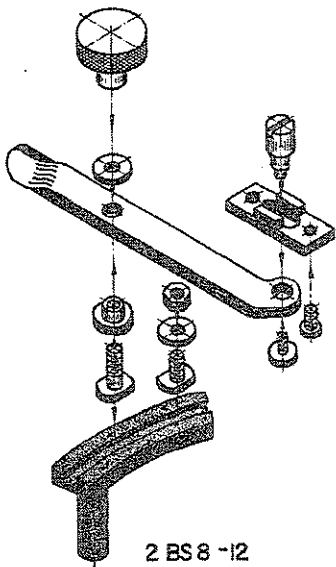

2 BS 8 -12

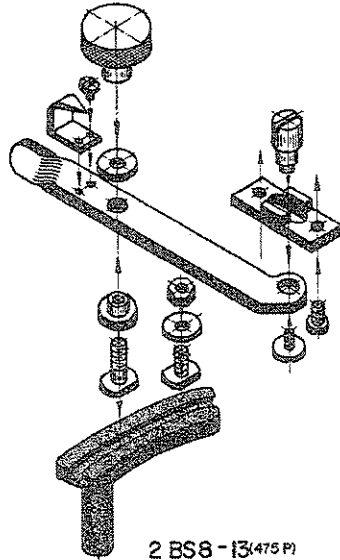

2 BS 8 -13 (475 P)

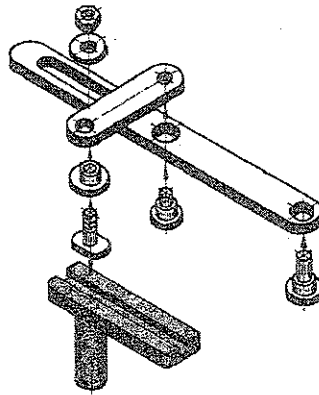

2 BS 8 -14

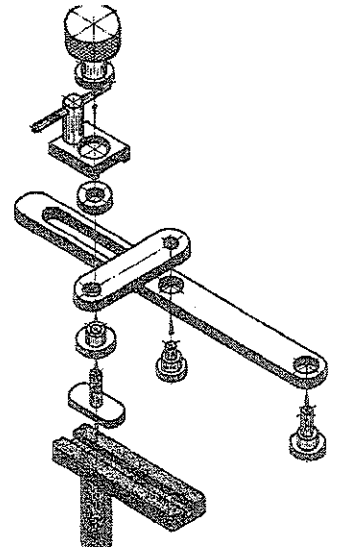

2 BS 8 -15 (475 P)

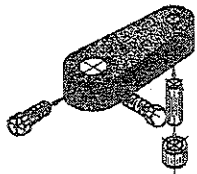

2 BS 8 -16

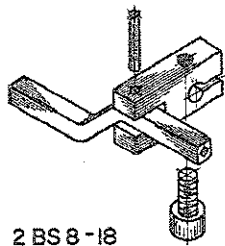

2 BS 8 -18

HAND - BUTTON - SEWER
CHANDLER MACHINE CO.
Pat. U.S. & Can.

WHEN ORDERING ANY
OF THESE UNITS
COMPLETE, REFER
TO NUMBER ON
THIS PAGE ONLY.

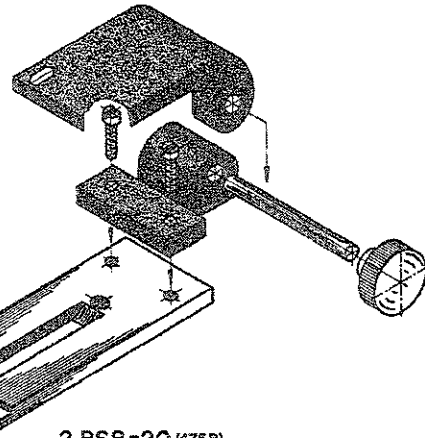

2 BS 8 -20 (475 P)

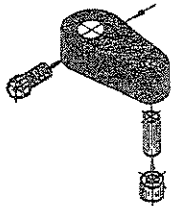

2 BS 8 -17

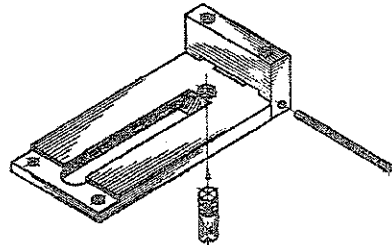

2 BS 8 -19



2 BS 8 -21
(475 P)

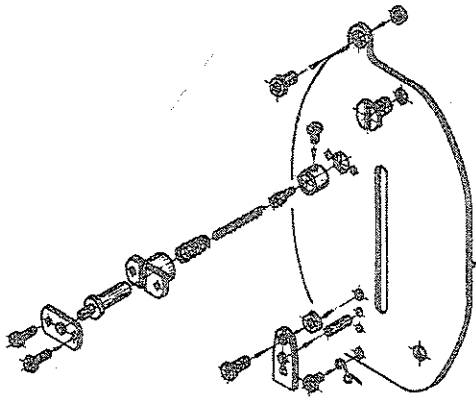

2 BS 8 - 1

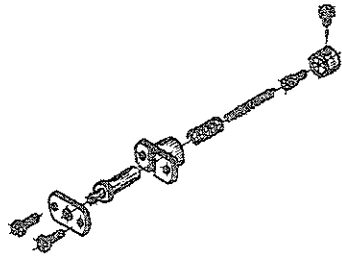

2 BS 8 - 2

BUTTON-SEWER
CHANDLER MACHINE CO.
cc

WHEN ORDERING ANY OF THESE UNITS
COMPLETE, REFER TO NUMBER ON THIS
PAGE ONLY.



2 BS 8 - 3



2 BS 8 - 4



2 BS 8-5

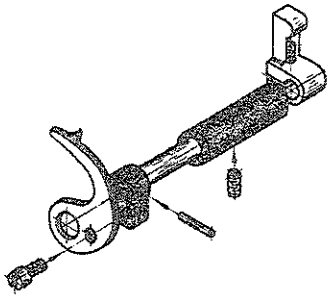

2 BS8 - 6

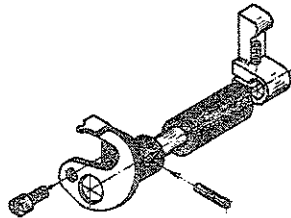

2 BS8 - 7 (475 P)

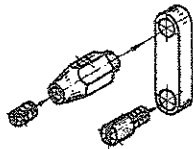

2 BS 8 - 8

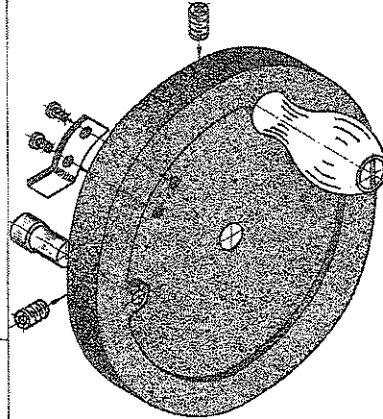

2 BS 8 - 9



2 BS8-10



2 BS8-11

HAND BUTTON SEWER 475 P

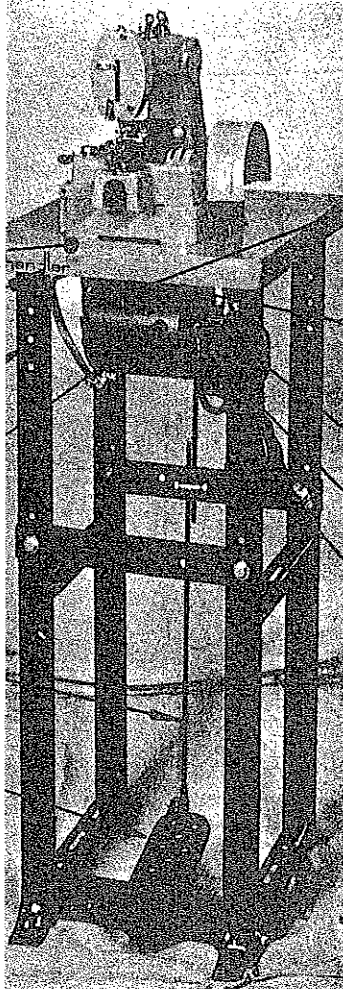

Please note:
Chandler Models 401, 461, 471, 481,
472, 475P & 485P are also represented in this book.

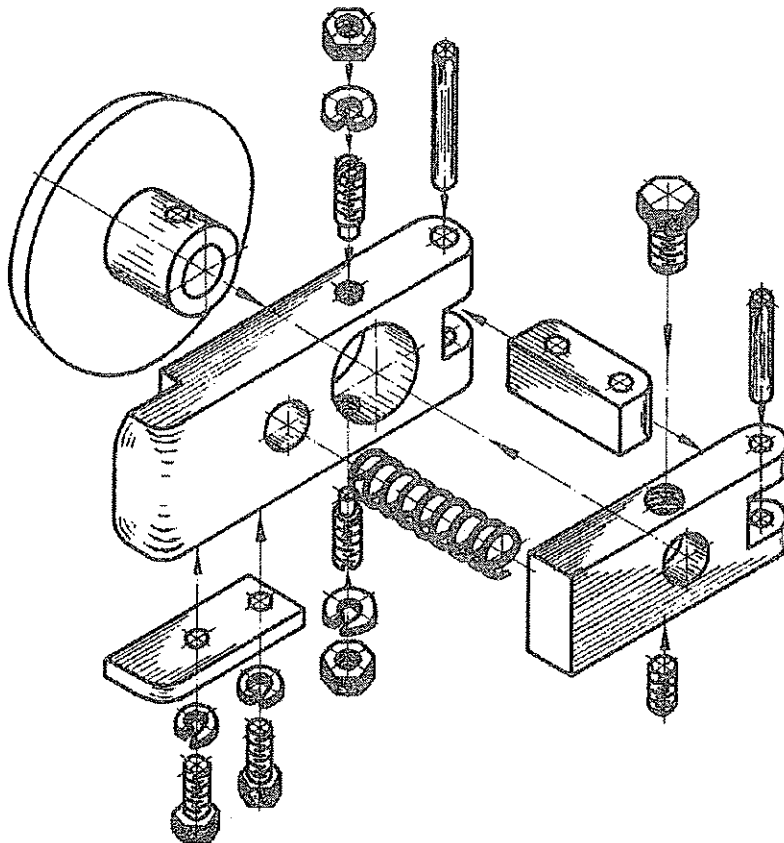

2 BS 8-24 (475P)

WHEN ORDERING ANY OF THESE UNITS COMPLETE, REFER TO NUMBER ON THIS PAGE ONLY.

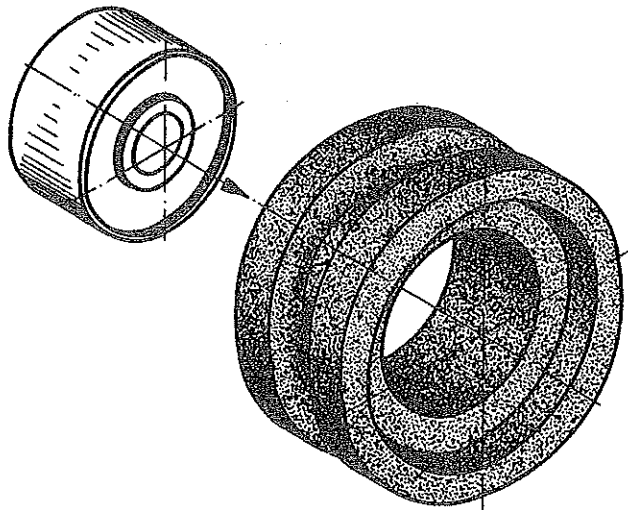

2 BS 8-25 (475P)

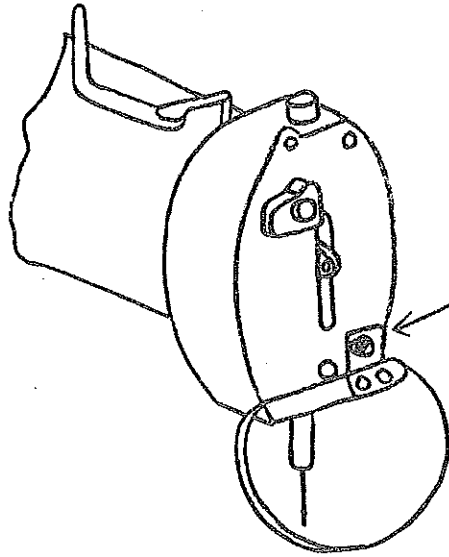

USE THIS SCREW TO ATTACH
COMBINATION FINGER AND
EYE GUARD.

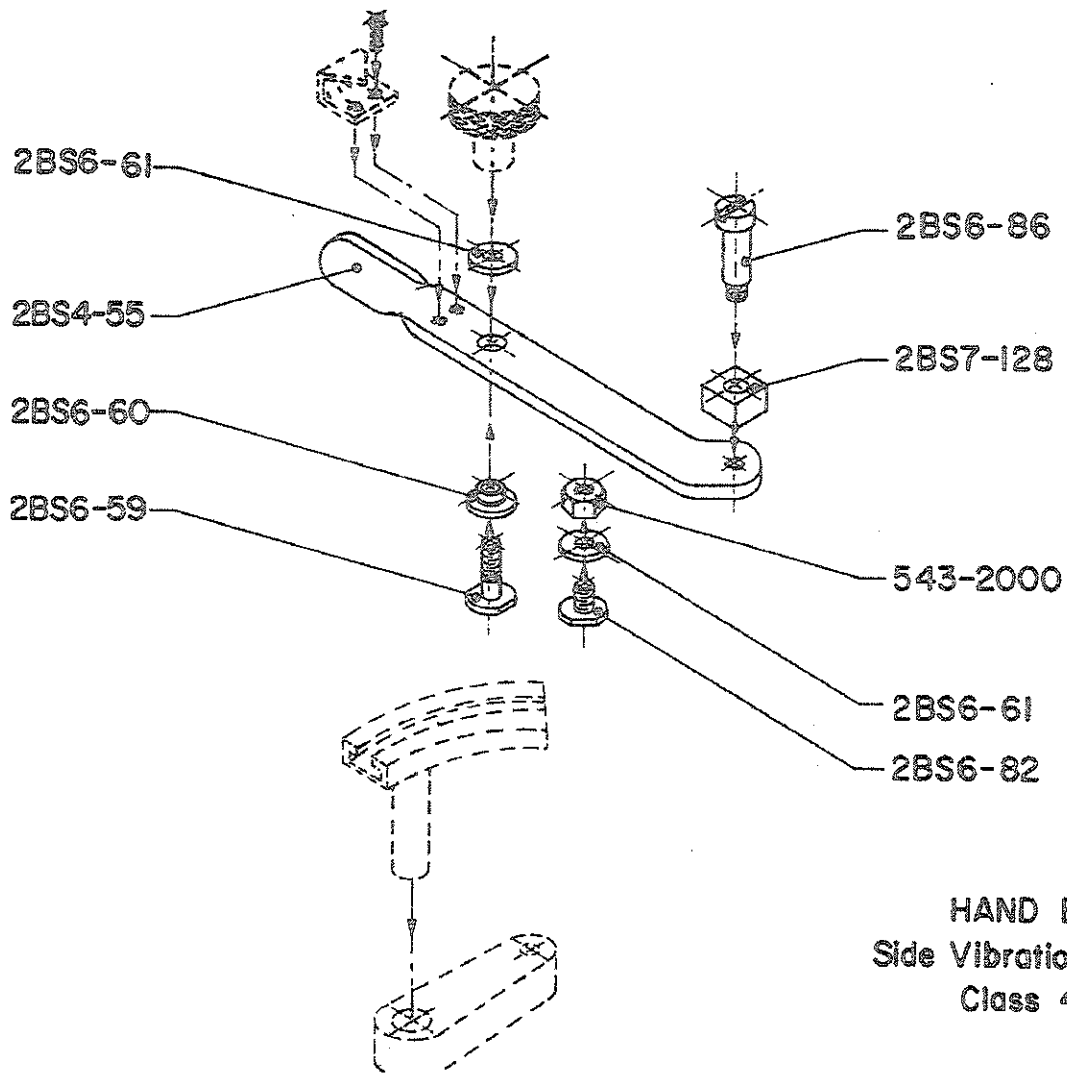

HAND BUTTON SEWER
 Side Vibration Mechanism Revision
 Class 48I and 485-P

INSTRUCTIONS FOR INSTALLING CLUTCH UNIT ON

472 & 475P & 485P

Refer to parts book re: part numbers

With needle bar in highest or stop position, and stop shaft 2BS3-184 protruding approximately 3/8", the clutch assembly is positioned on clutch shaft 2BS3-195 so that the stop shaft is relieving tension from the clutch, allowing pulley to spin freely. Cap screw will be tightened on flat of shaft and Allen screw on bottom is also tightened. With power off, run the machine thru one cycle by hand. When stop shaft is activated, part No. 2BS-7180, stop blade, should be under leading end of stop shaft, the needle bar should be in its highest position, and the pulley should be free of the clutch, with a minimal amount of clearance. Any adjustments for this should be made by moving stop shaft in or out which is governed by the collar inside the machine. With the machine running, the stop blade should be clearing the stop shaft by approximately 1/32 of an inch.

Chandler

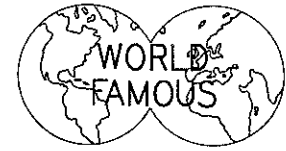

MAIN office

131 W. 25th Street
New York, NY 10001
Tel: 212-741-7788
Fax: 212-741-7787

Miami, FL

4013 N.W. 79th Avenue
Miami, FL 33166
Tel: 305-471-0200
Fax: 305-471-0243

Los Angeles, CA

2320 South Hill Street
Los Angeles, CA 90007
Tel: 213-745-8844
Fax: 213-745-8855